

Desarrollo: 795.5  
(E. 1.5)

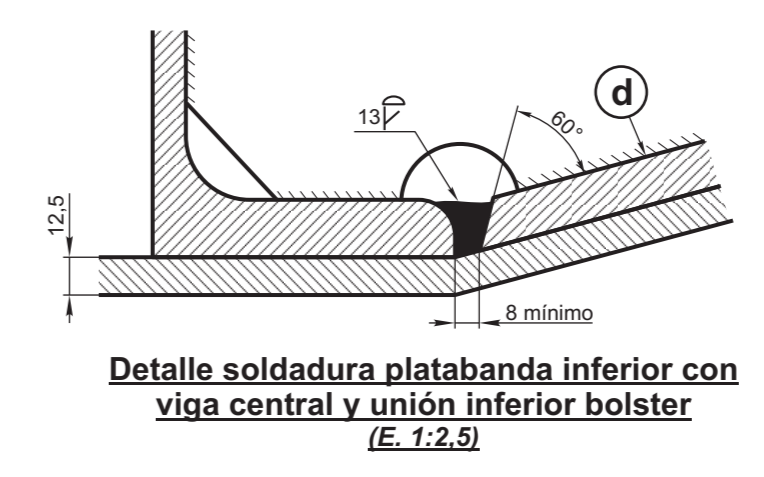
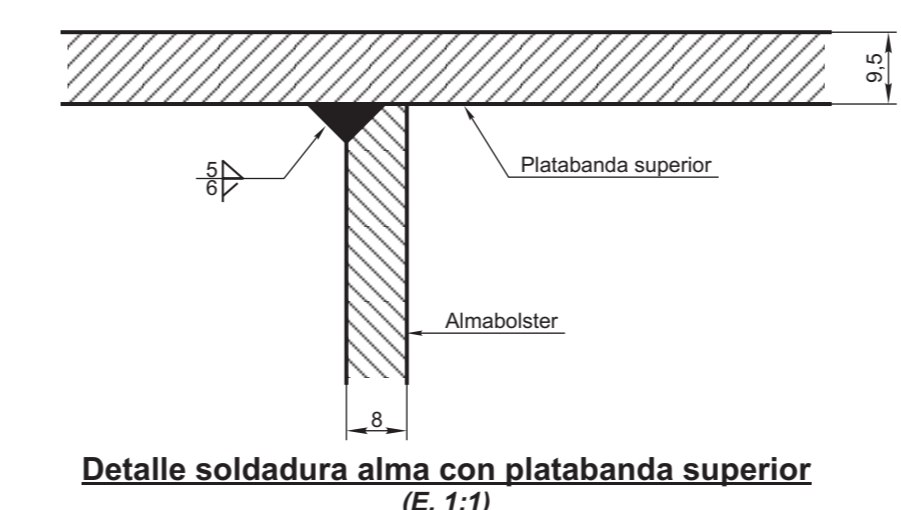
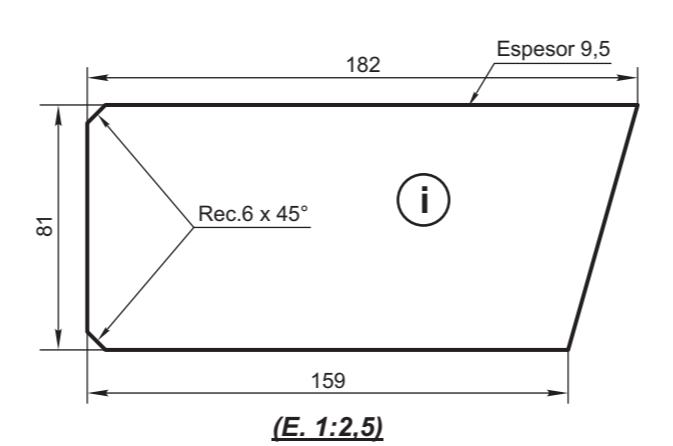
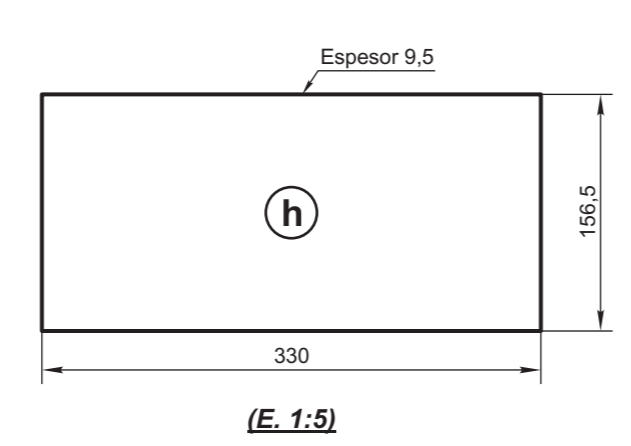
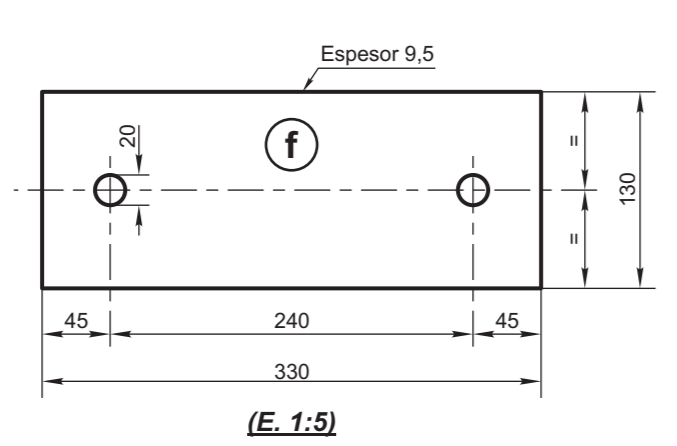
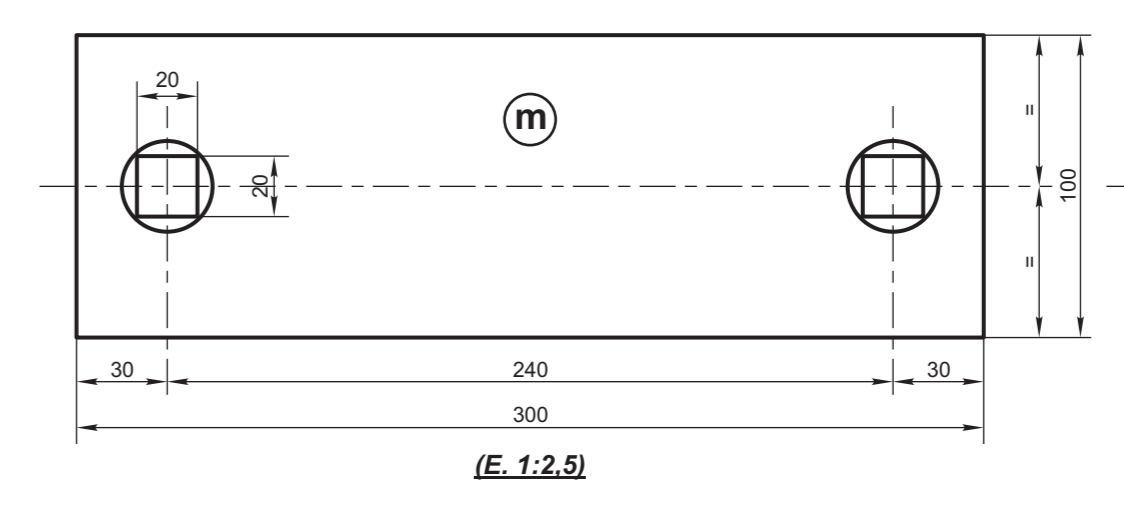
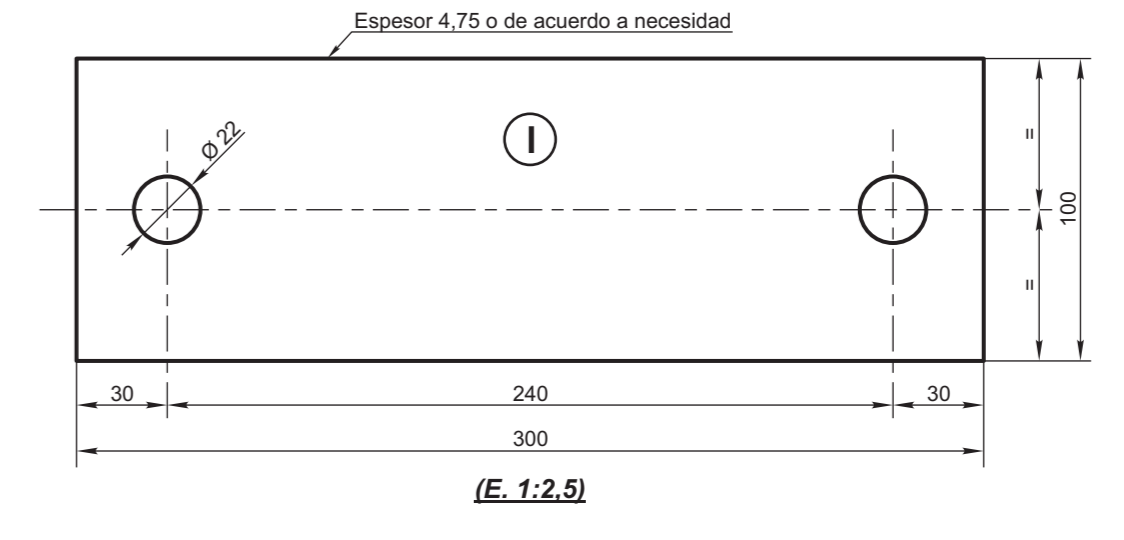
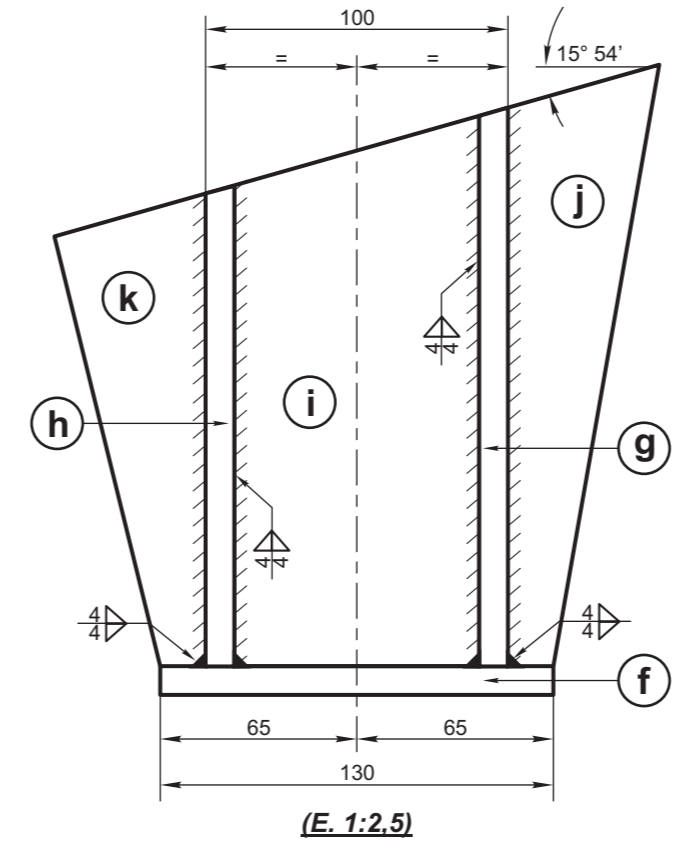
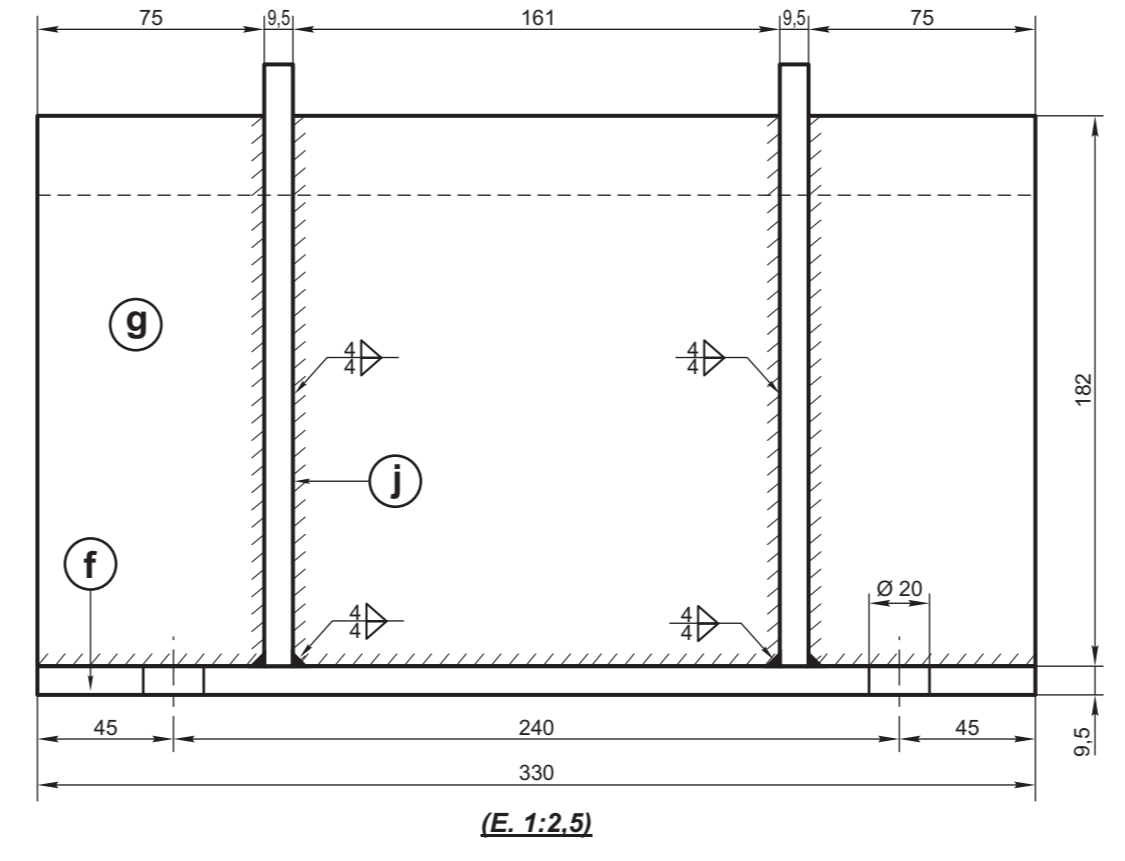
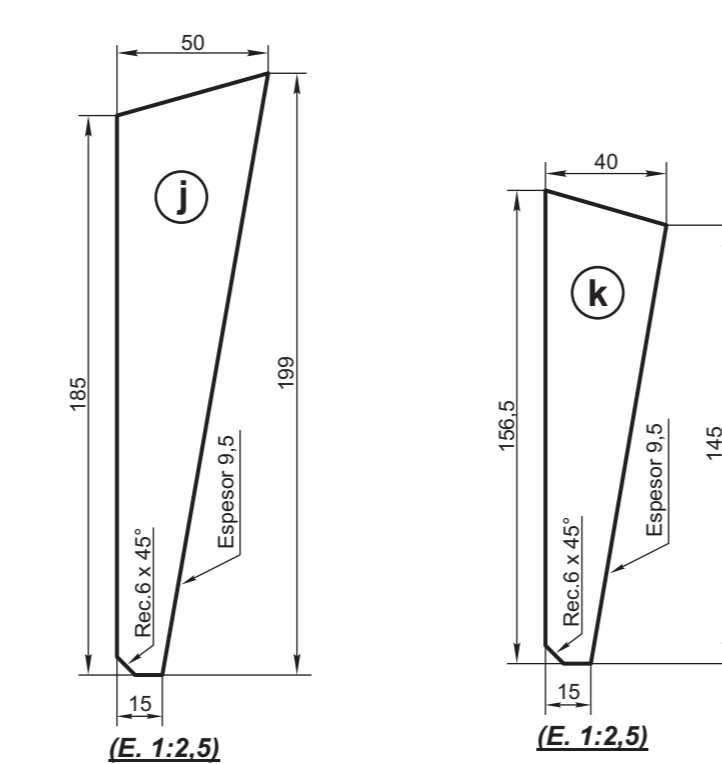
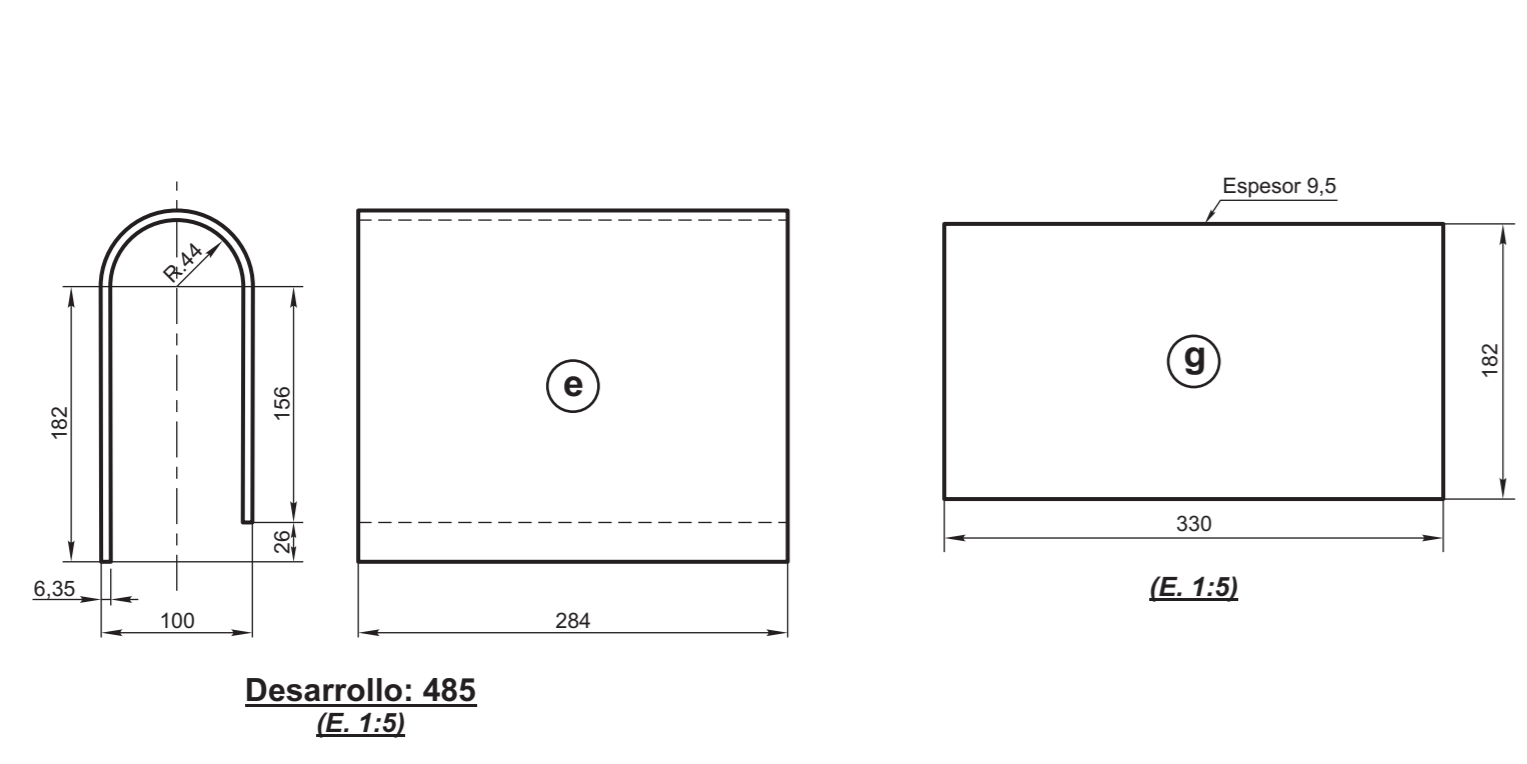

Cant/Vagón: 2

ITEM	DESCRIPCION	CANT	ESPECIFICACIONES Y OBSERVACIONES	CATALOGO
n	Chapa cierre	4	≠ 8 IRAM 503 F24	
m	Patin lateral	4	≠ 19 IRAM 503 F24	
l	Supl. de ajuste	4	IRAM 503 F24	
k	Refuerzo lateral	8	≠ 9,5 IRAM 503 F24	
j	Refuerzo lateral	8	≠ 9,5 IRAM 503 F24	
i	Refuerzo central	8	≠ 9,5 IRAM 503 F24	
h	Lateral caja	4	≠ 9,5 IRAM 503 F24	
g	Lateral caja	4	≠ 9,5 IRAM 503 F24	
f	Soporte patin	4	≠ 9,5 IRAM 503 F24	
e	Refuerzo sipatin	4	≠ 6,35 IRAM 503 F24	
d	Platabanda inferior	4	≠ 9,5 IRAM 503 F24	
c	Platabanda superior	2	≠ 9,5 IRAM 503 F24	
b	Alma	4	≠ 8 IRAM 503 F24	
a	Alma	4	≠ 8 IRAM 503 F24	

ITEM	DESCRIPCION	CANT	ESPECIFICACIONES Y OBSERVACIONES	CATALOGO
<b>VAGON TOLVA ABIERTO PARA PIEDRA</b>				
<b>TRAVESAÑO SOBRE BOGIE</b>				
AREA MECANICA				
ESCALA	TROCHA	LINEAS	UTILIZACION	EMISION
1676				2
Nº DE PLANO				
NEFA 32.056				

TOLENCIAS GENERALES  
 PIEZAS UTILIZADAS : 0,25 mm  
 PIEZAS FORJADAS : 0,8 mm  
 PIEZAS EN CHAPAS : 0,5 mm  
 ANGULOS : 0,30°  
 MAYOR CANTOS VIVOS