

**PERFIL NORMAL**  
Esc: 1:1

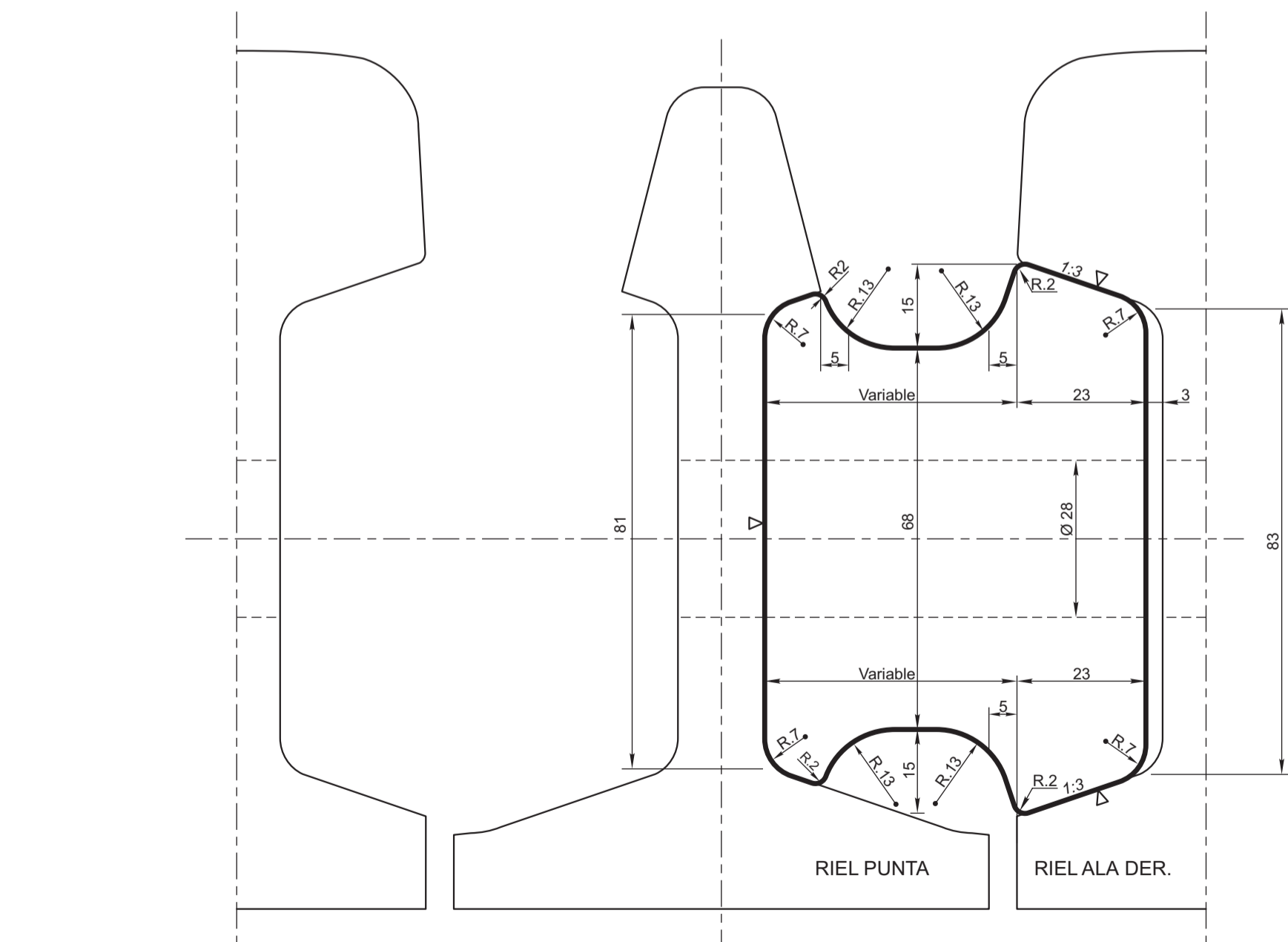

**1/2 PERFIL DE CONTACTO 1/2 PERFIL NORMAL**  
Esc: 1:1

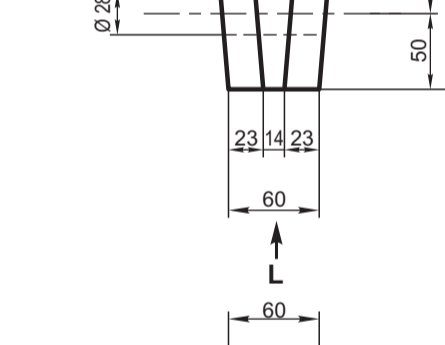
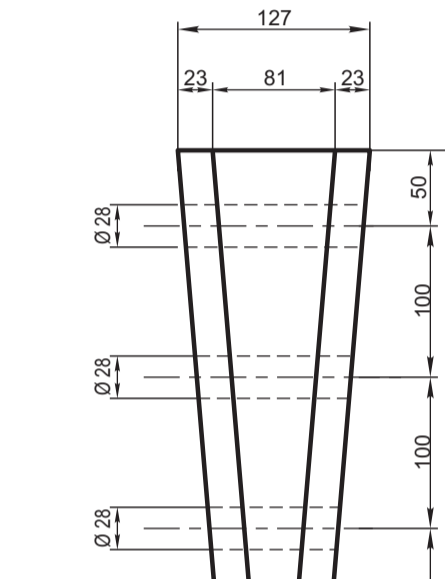
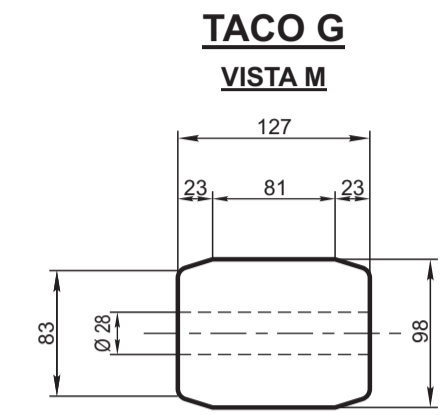
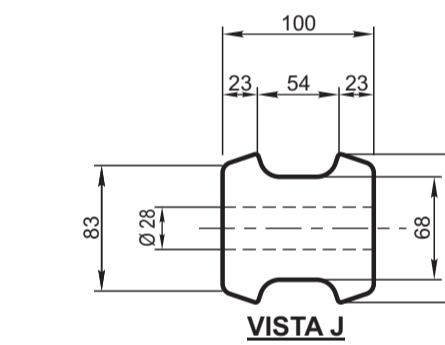
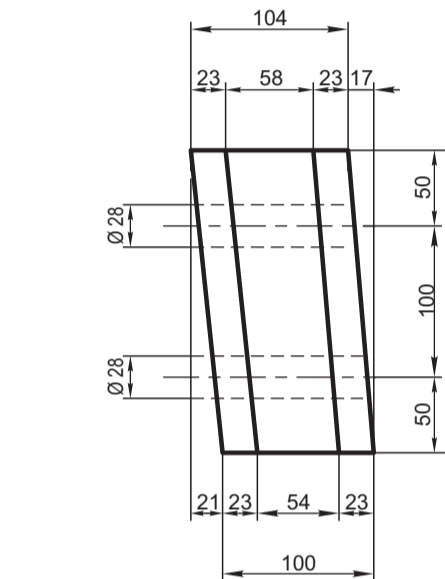
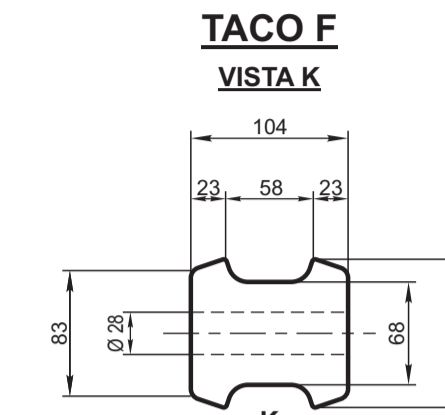
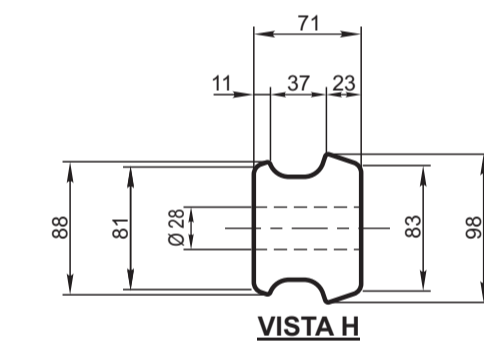
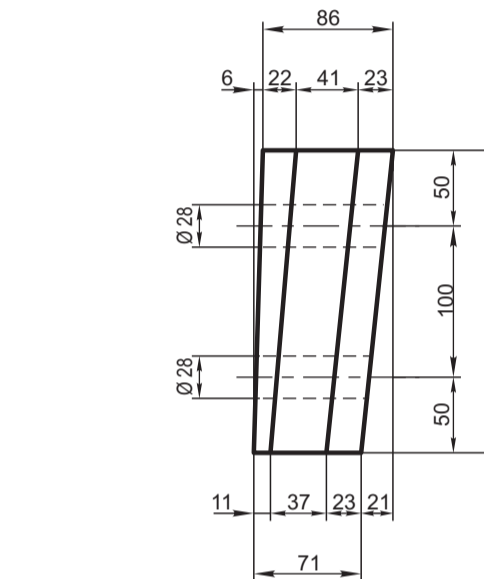
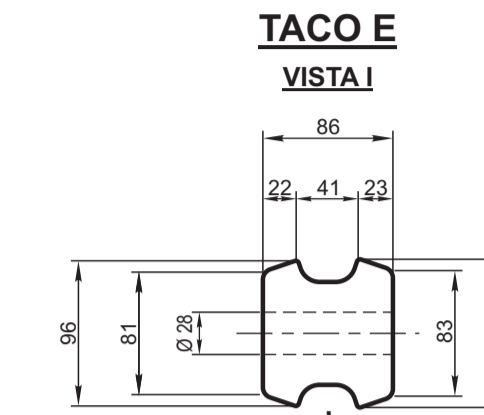
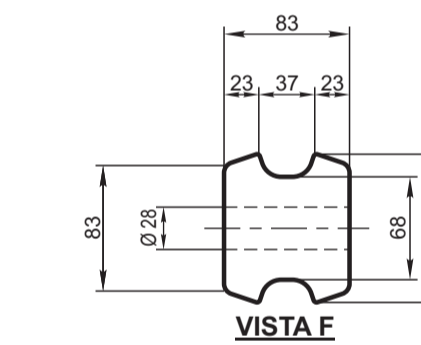
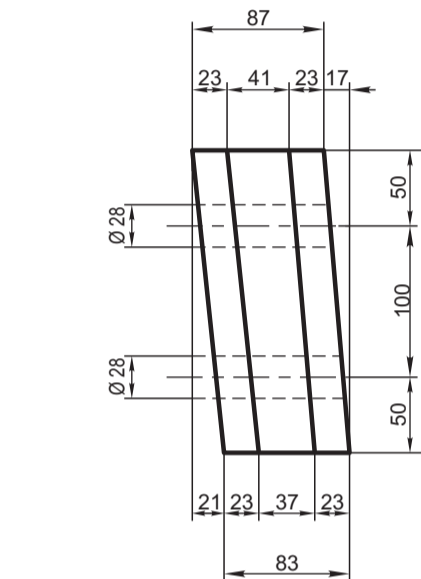
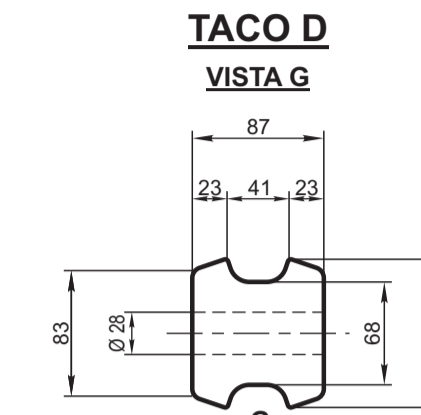
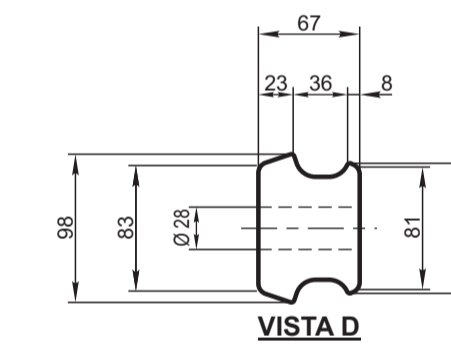
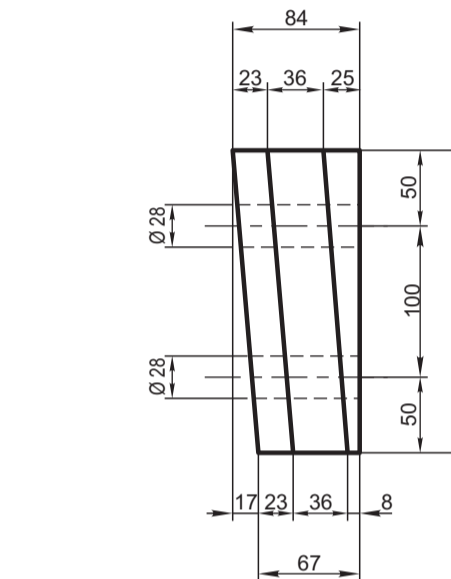
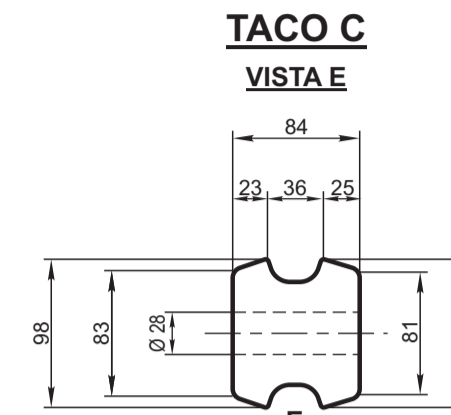
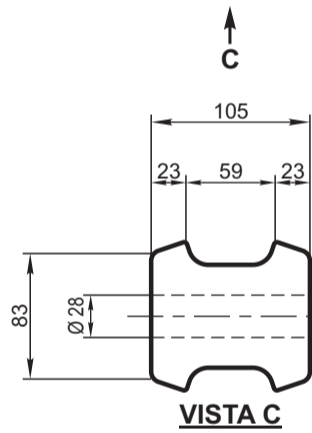
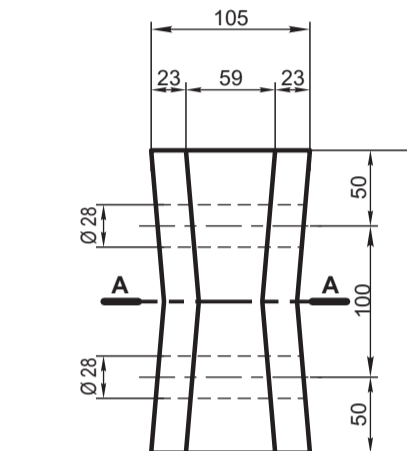
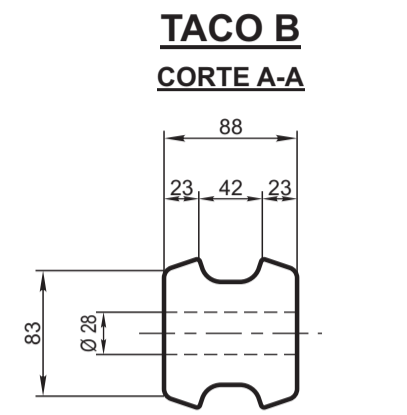
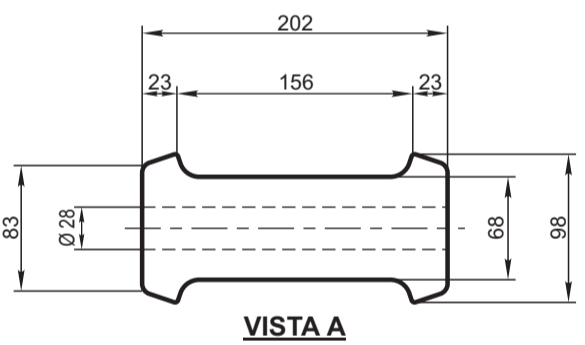
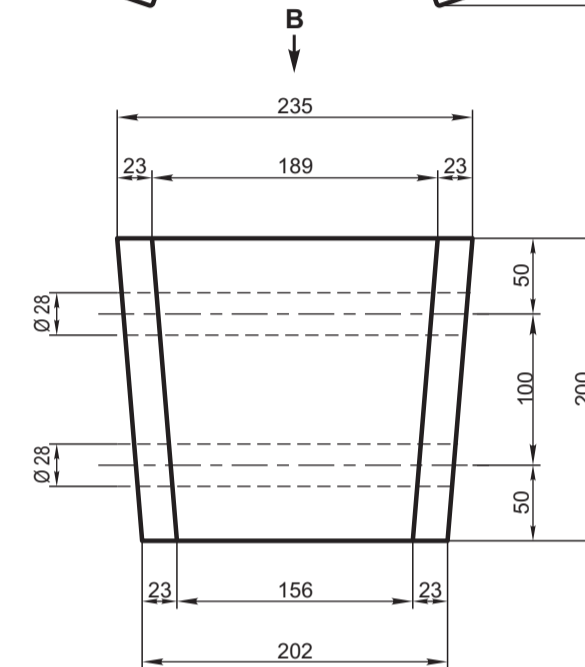
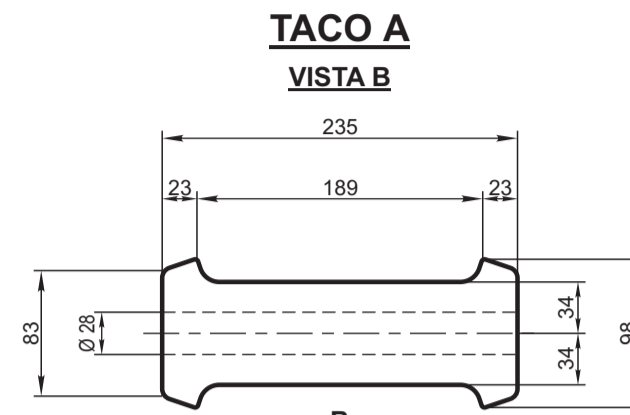

**ESQUEMA DISTRIBUCION DE TACOS**  
Esc: 1:20

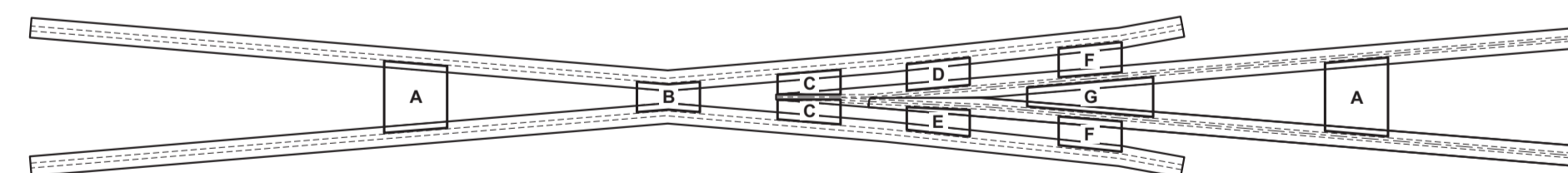

**NOTAS:**  
Todas las superficies a maquinar deben estar sobredimensionadas en 1 mm.  
< Superficies a maquinar en el armado del corazón.  
Material: Fundición gris según Especificación F.A. 8 718

2	Nota de sobredimensionamiento	11/12/85
EMISION	COTA	FECHA - FIRMA
ALTERACIONES		

REF.	DESCRIPCION	CANT.	PLANO	NORMA/MATERIAL
	<b>CORAZON AGUDO Tg 1:5,958 TACOS DE DISTANCIA RIEL U.36</b>			<b>FERROCARRILES - ARGENTINOS</b>
				AREA VIA Y OBRAS
ESCALA 1:1 - 1:5	TROCHA TODAS	LINEAS:	UTILIZACION VIA	EMISION 1 2
FIRMA Y FECHA APROB.			N° DE PLANO <b>G.V.O. 746</b>	