

**NOTA:**  
Lista de materiales Plano Cr-1-5  
Silletas Plano GVO 674 (Cr-9-5-9-3)

**PLANTA**  
Esc. 1:7,5

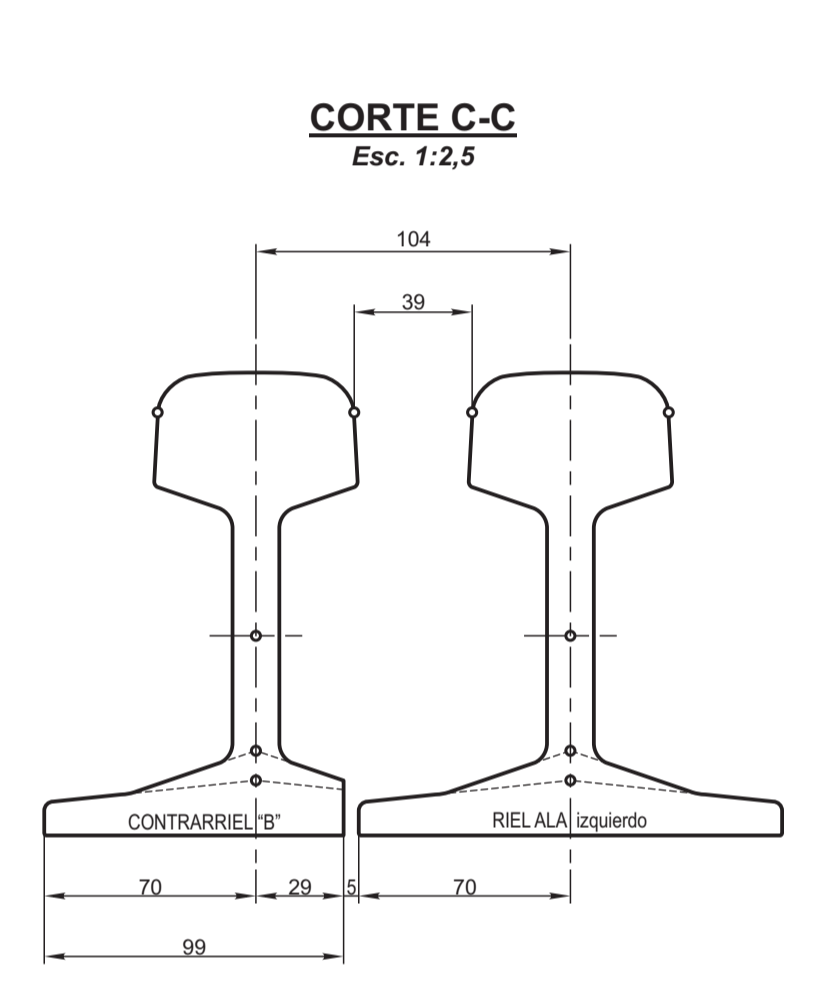

**CORTE C-C**  
Esc. 1:2,5

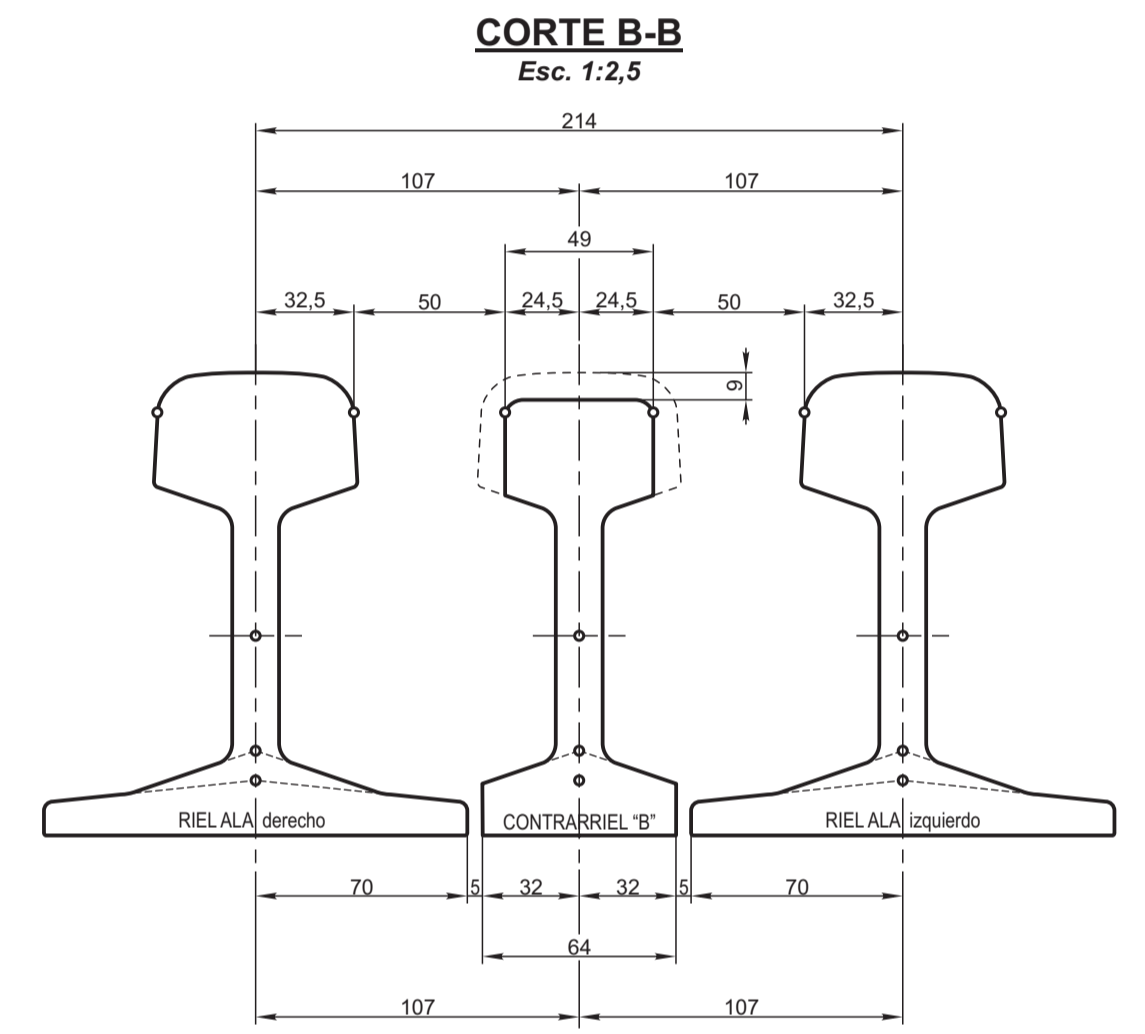

**CORTE B-B**  
Esc. 1:2,5

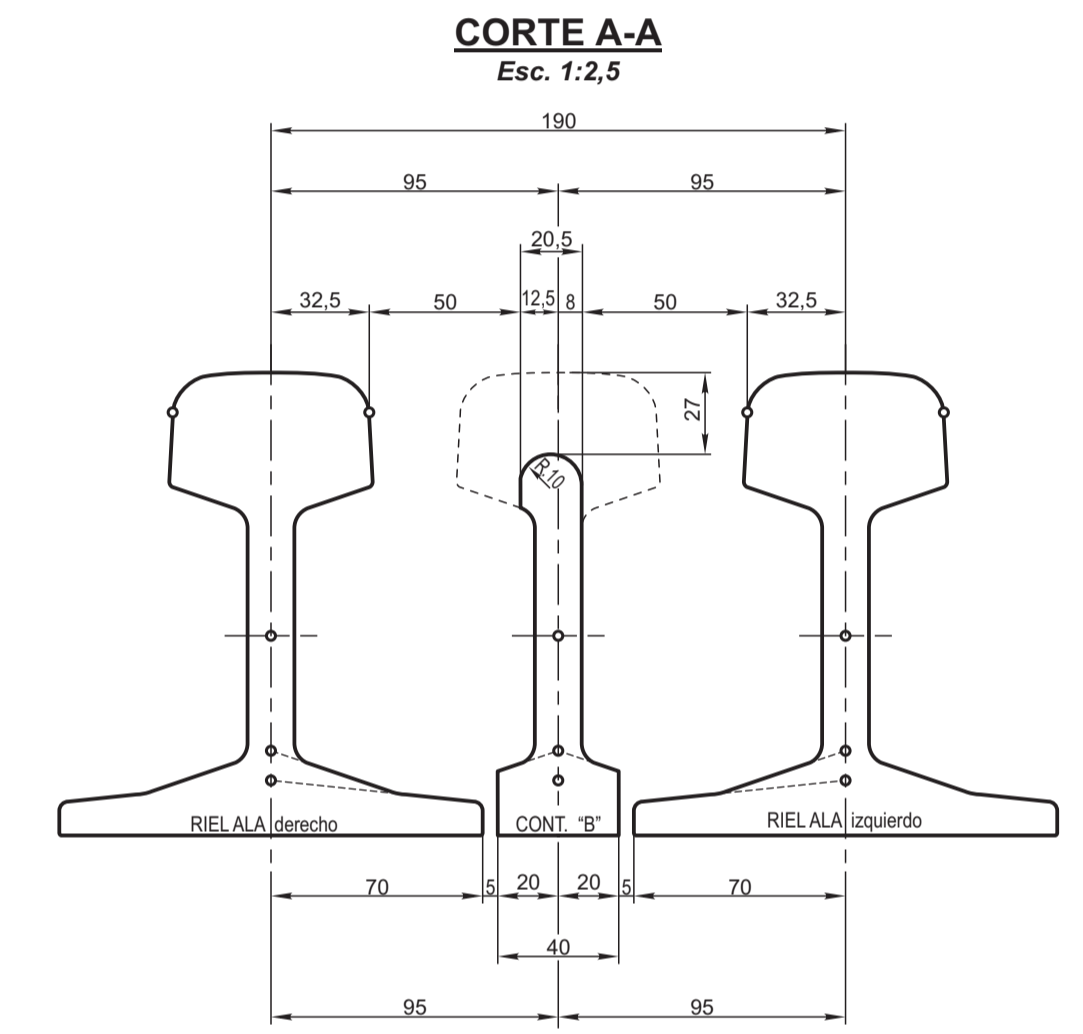

**CORTE A-A**  
Esc. 1:2,5

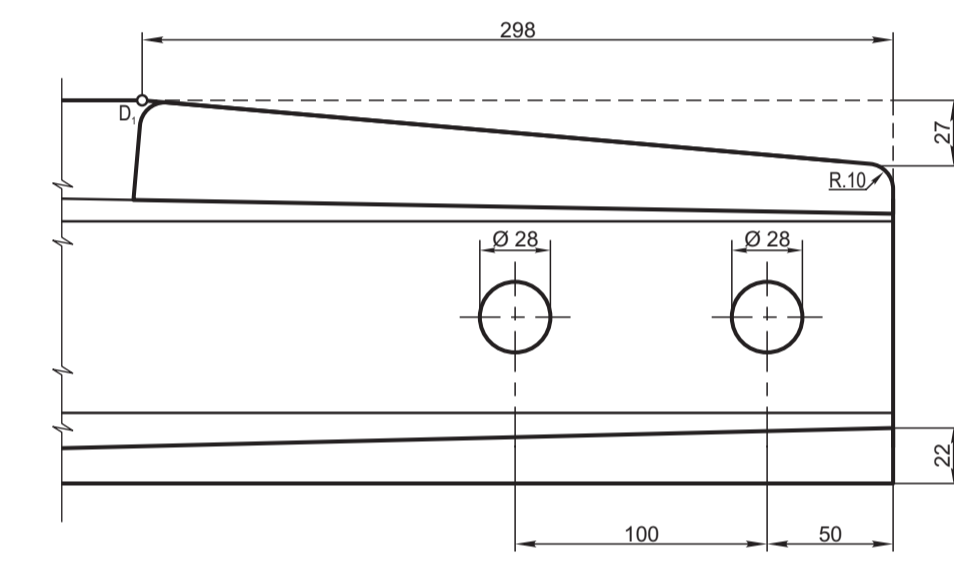

**DETALLE DE LA PUNTA**  
S/Escala

**DIAGRAMA DE DOBLADURA - AGUJEREADO Y CEPILLADO DEL CONTRARRIEL**  
Esc. 1:10

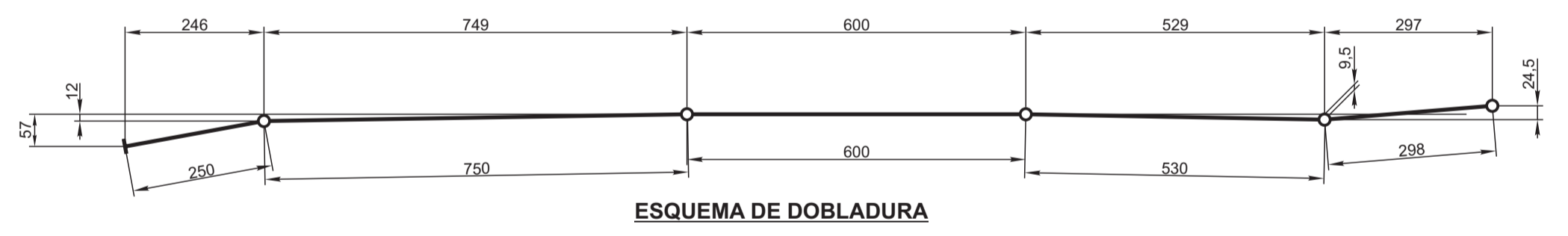

**ESQUEMA DE DOBLADURA**

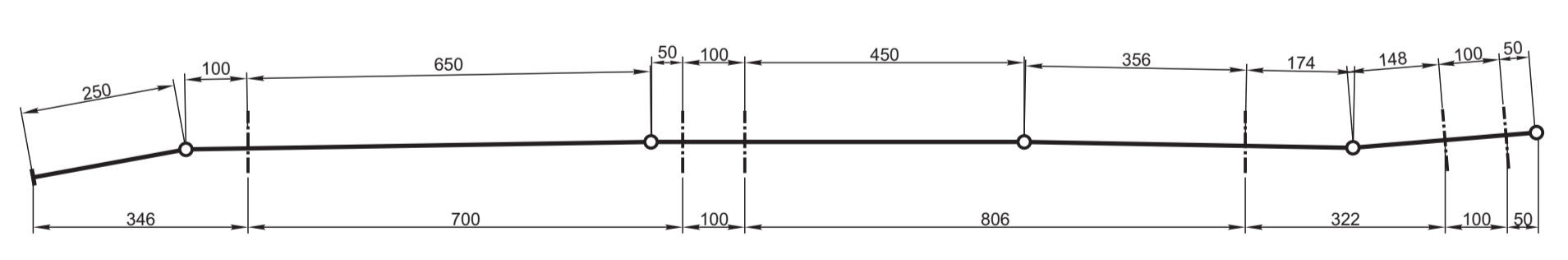

**ESQUEMA DE AGUJEREADO**

**NOTA:** Todos los agujeros serán de Ø 28 mm

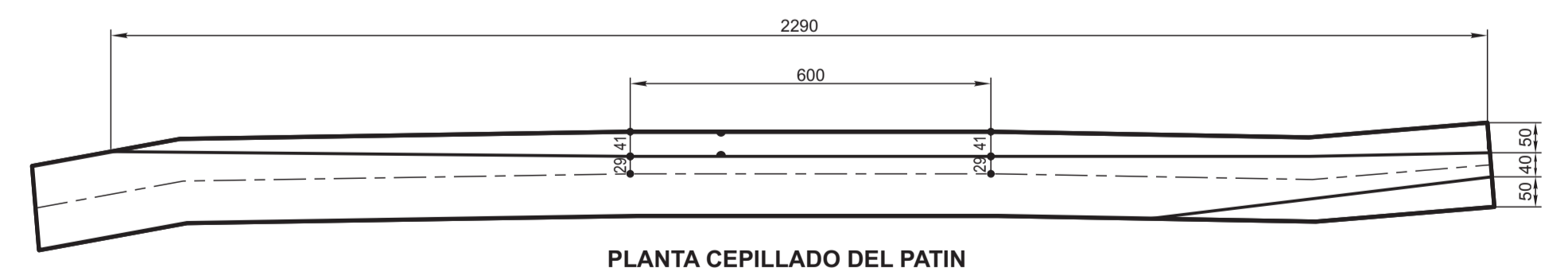

**PLANTA CEPILLADO DEL PATIN**

**NOTA:** El cepillado del patin es recto y paralelo al sector acotado 600

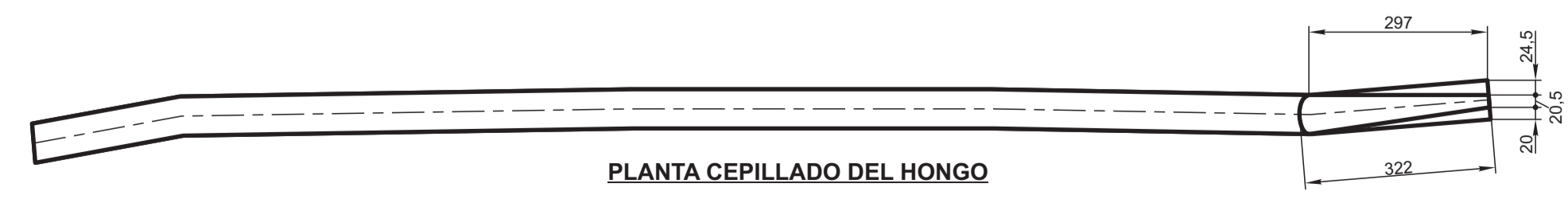

**PLANTA CEPILLADO DEL HONGO**

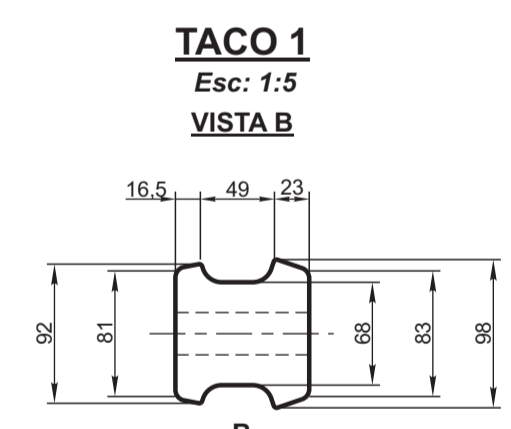

**TACO 1**  
Esc. 1:5  
VISTA B

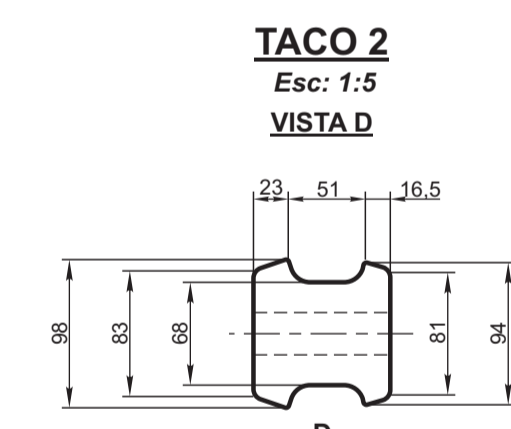

**TACO 2**  
Esc. 1:5  
VISTA D

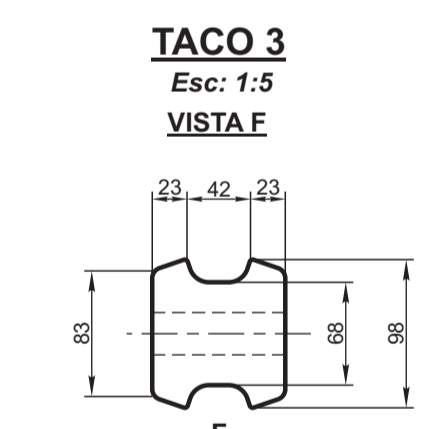

**TACO 3**  
Esc. 1:5  
VISTA F

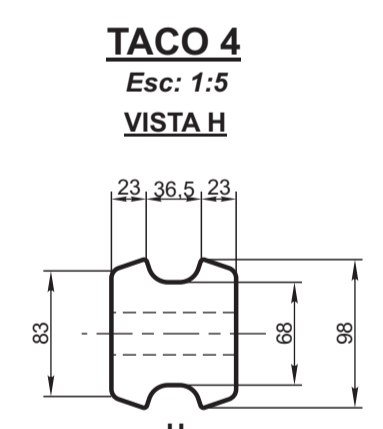

**TACO 4**  
Esc. 1:5  
VISTA H

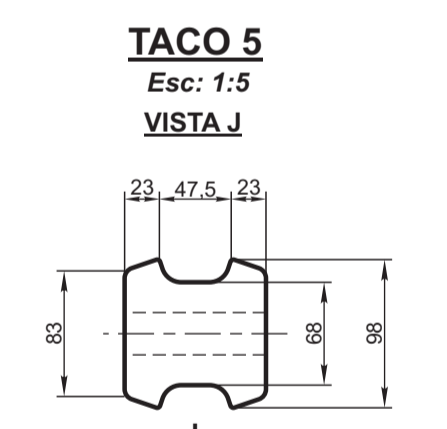

**TACO 5**  
Esc. 1:5  
VISTA J

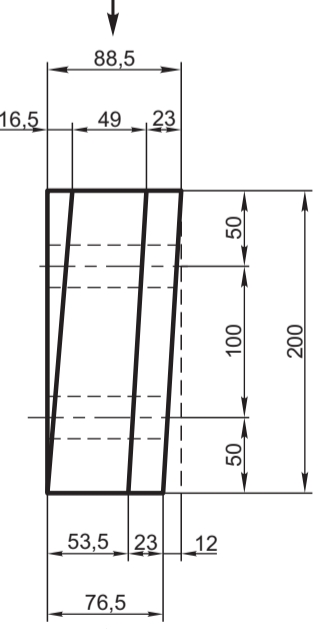

**VISTA A**

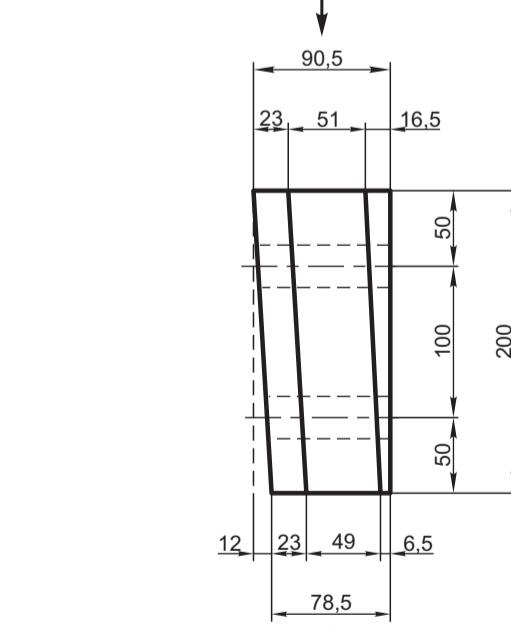

**VISTA C**

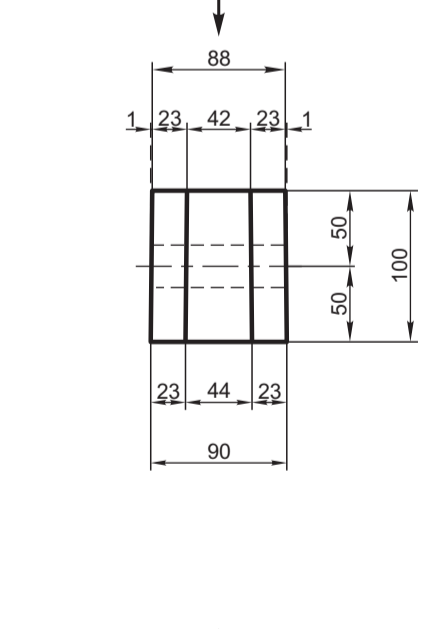

**VISTA E**

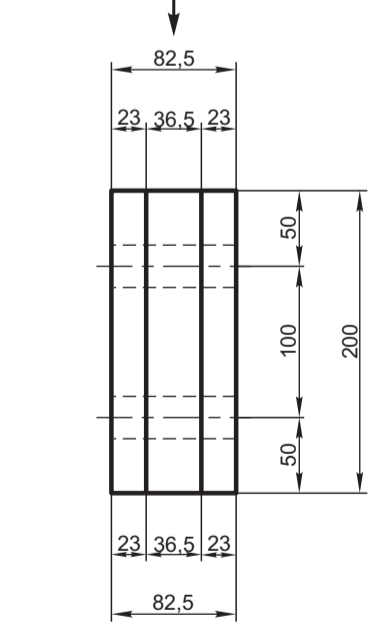

**VISTA G**

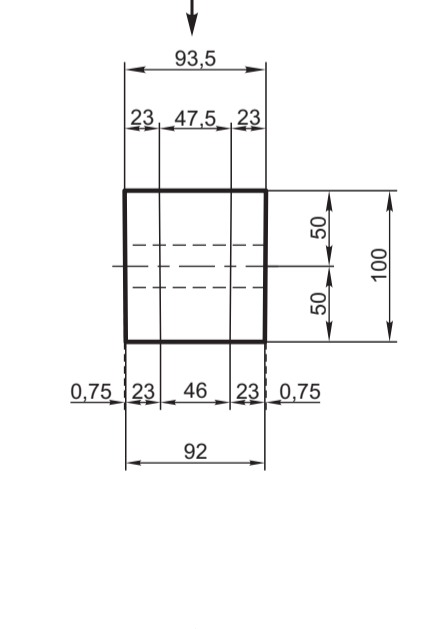

**VISTA I**

**NOTAS:**  
Los perfiles normales de los tacos figuran en Plano Cr.1-5-2-2 (GVO. 670).  
El diámetro de los agujeros de todos los tacos es de 28 mm.

<b>CONTRARRIEL "B"</b> DETALLE - CORTES - DOBLADURA AGUJEREADO - CEPILLADO - TACOS DE DISTANCIA RIEL 50 kg - U.36		<b>FERROVIARIOS ARGENTINOS</b>		
		AREA VIA Y OBRAS		
ESCALA 1:2.5 - 1:5 1:7.5 - 1:10	TROCHA 1676	LINEAS TODAS	UTILIZACION VIA	EMISION 1
FIRMA Y FECHA APROB.		N° DE PLANO G.V.O. 668		1